





LTE: 410MHz-470MHz, 690MHz -960MHz, 1710MHz – 2700MHz, 3400MHz-3800MHz.

WiFi: Dualband 2.4GHz & 5GHz

GPS/GLONASS



Model	Description			
MIMO-0003-12	2-in-1 Antenna LTE (2x2 MIMO)	2x2 MIMO		
MIMO-0003-13	3-in-1 Antenna LTE (2x2 MIMO) & GPS	2x2 MIMO		✓
MIMO-0003-15	5-in-1 Antenna LTE (2x2 MIMO), Dualband WiFi (2x2 MIMO) & GPS	2x2 MIMO	2x2 MIMO	✓

MIMO-0003-V2 Series | LTE, WiFi & GPS Antennas for Transportation

KEY FEATURES

- Ultra-wideband 410MHz to 470MHz, 690MHz to 2700MHz and 3400MHz to 3800MHz bands
- Water & dust protected (IP68)
- Highly Ruggedised (complies with IK10)
- Fire Resistant Cables (certified with ECE-R 118.02)
- Easy installation; multi implementation options:
 - Spigot Mount (2x standard lengths supplied) – spigots can also be removed for surface mount and magnetic mount.
 - Surface Mount (Double Sided Tape)
 - Surface Mount (via 6x screws)
 - Magnetic Mount (optional)
- UV Stable Enclosure
- Wideband - covers wide frequency band
- Ground plane independent – does not need to be mounted on metal surfaces.
- 5G Ready; includes 3.4GHz to 3.8GHz CBRS Band

KEY IoT/M2M APPLICATION AREAS

- Transport broadband and Wi-Fi distribution, automation and telemetry for Busses, Utility, Trucking & Public Safety vehicles
- Industrial factory automation, robotic machinery and other M2M systems telemetry
- Farming & Agricultural automation such as M2M & IoT
- Broadband cellular to WiFi distribution for Marine / Boats (inland and near coastal vessels)
- Mining Vehicles & Machinery communications, telemetry and automation (M2M & IoT)

MIMO-0003-V2 Series

©2018 Poynting Antennas (Pty) Ltd. All rights reserved
Product Specifications may change without prior notice
Revised: October 2018



Regulatory Compliance: RoHS 2011/65/EU Compliant | ISO 9001:2015

Document version: PRODUCTBRIEF_MIMO-0003-V2_REV0.2

www.poynting.tech



LTE: 410MHz-470MHz, 690MHz -960MHz, 1710MHz – 2700MHz, 3400MHz-3800MHz.

WiFi: Dualband 2.4GHz & 5GHz

GPS/GLONASS

Product Overview

The MIMO-0003-V2 series is aimed at the Transportation and Marine industries, deployed for broadband internet services, telemetry and IoT/M2M. The 5-in-1 flagship of this range, the MIMO-0003-V2-15, boasts 2x2 MIMO LTE, 2x2 MIMO WiFi (Dualband 2.4GHz & 5GHz) and GPS/GLONASS. Other variants offer a subset of this configuration. The MIMO-0003-15 incorporates 5 antennas in a single antenna housing, providing 2x Cellular, 2x Wi-Fi and a GPS.

The MIMO-0003-V2 series is the evolution of the previous MIMO-0003 antenna, where the permanent spigot was removed and the antenna mounting options were enhanced to make this antenna easier to implement; whether it is with its removable two length spigots or surface mount, where the coax cables are routed neatly out the rear side of the antenna.

The 2x Cellular MIMO antennas (for 2G/3G/4G/5G) cover the 410MHz to 3800MHz band, and two separate dual-band Wi-Fi antennas, providing concurrent 2.4GHz and 5GHz on each antenna, capable of 802.11n and of 802.11ac with 2x2 MIMO. The fifth antenna is a high-performance active GPS/GLONASS system operating down to -40 degrees and up to 80 degrees Celsius for the most taxing environments.

This antenna provides complete water and dust protection in the most severe storms, where the antenna can even be submerged under water as it is designed according to IP68 specifications. The SAN Marine ASA plastics used offer UV stability, protection against the harsh sun and chemical spill resistance. The antenna radome is protected against salt water spray and can be used at sea, and inland.

The antenna exceeds the performance of most competitors due to the attention to the design of this high-performance antenna. The radiation patterns of all radiating elements provide an excellent balance between omnidirectionality, gain and good radiation abilities at the desired elevation, which is important for this type of antenna.

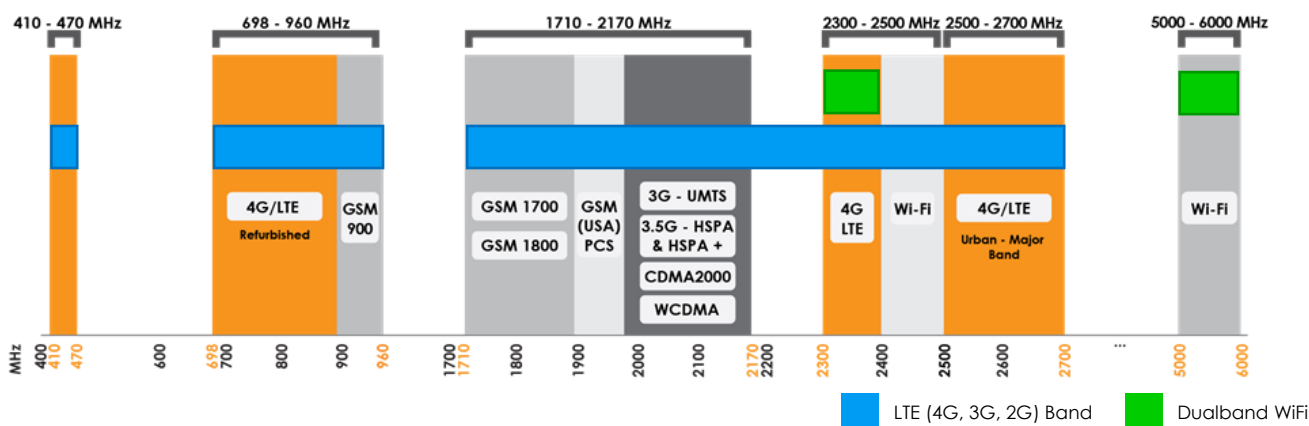

MIMO-0003-V2 Series

©2018 Poynting Antennas (Pty) Ltd. All rights reserved
Product Specifications may change without prior notice
Revised: October 2018



Regulatory Compliance: RoHS 2011/65/EU Compliant | ISO 9001:2015

Document version: PRODUCTBRIEF_MIMO-0003-V2_REV0.2

www.poynting.tech



LTE: 410MHz-470MHz, 690MHz -960MHz, 1710MHz – 2700MHz, 3400MHz-3800MHz.

WiFi: Dualband 2.4GHz & 5GHz

GPS/GLONASS

Mounting Possibilities

Poynting's updated MIMO-0003-V2 antenna range provides easy installation with the multiple mounting options.

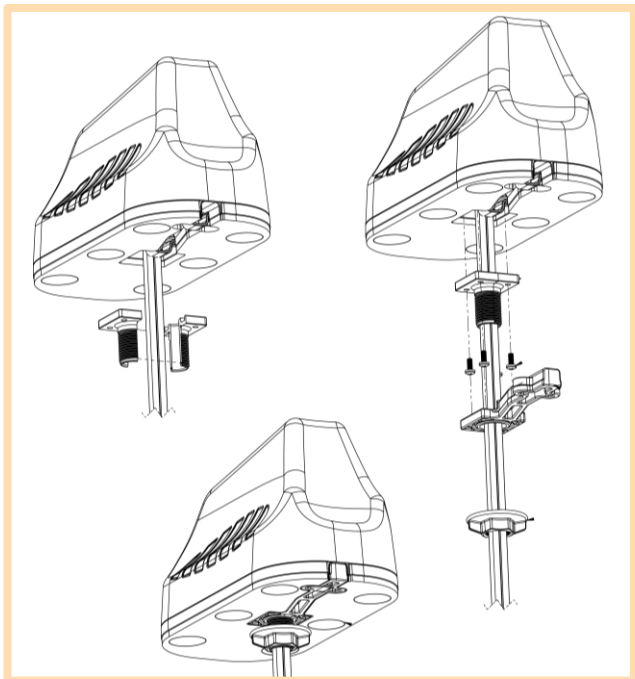

Standard Spigot Mount

Threaded Spigot Mounting – fully removable spigots.

Two Spigot lengths included 40mm & 80mm spigot.

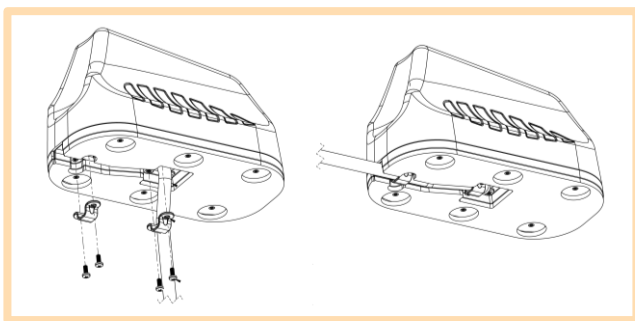

Surface Mount

Adhesive Surface Mounting for temporary installations. Screw mounting points (x6) for secure permanent surface mounting. can also be mounted on a custom bracket if required.

Cable routing channel for rear cable exit to support flush mounting.

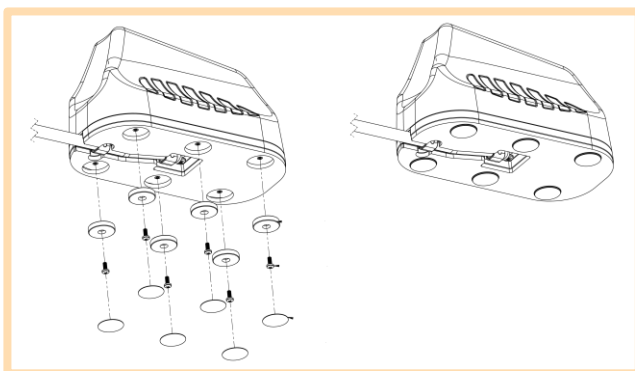

Magnetic Mount

Optional Magnetic Base Kit available for temporary installations.

MIMO-0003-V2 Series

©2018 Poynting Antennas (Pty) Ltd. All rights reserved
Product Specifications may change without prior notice
Revised: October 2018



Regulatory Compliance: RoHS 2011/65/EU Compliant | ISO 9001:2015

Document version: PRODUCTBRIEF_MIMO-0003-V2_REV0.2

www.poynting.tech



LTE: 410MHz-470MHz, 690MHz -960MHz, 1710MHz – 2700MHz, 3400MHz-3800MHz.

WiFi: Dualband 2.4GHz & 5GHz

GPS/GLONASS

Technical Drawing

The following technical drawing of the enclosure is an example of the dimensions, in this case the flagship MIMO-0003-V2-15.

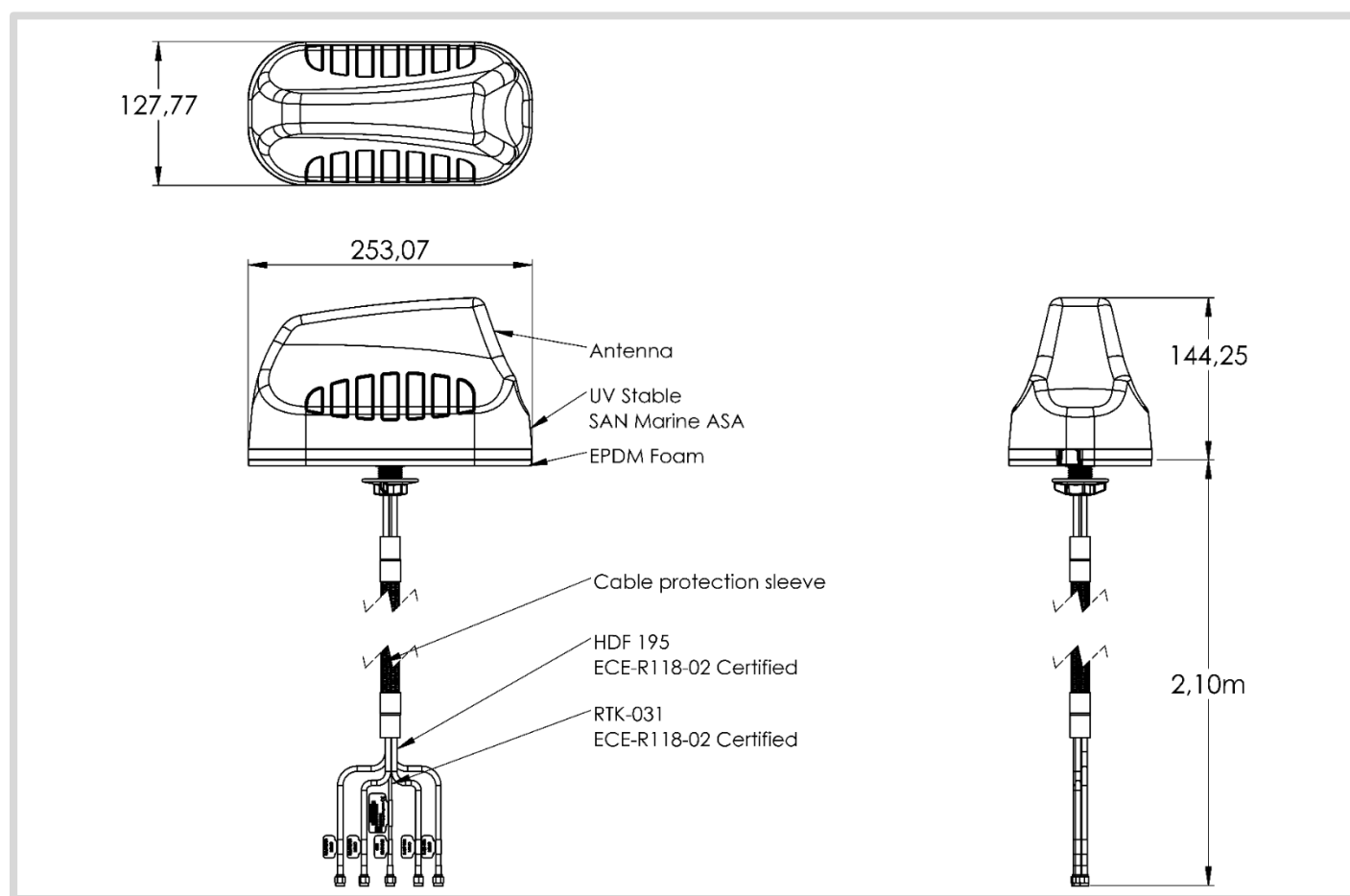

Figure 1 Technical drawing example of the MIMO-0003-V2-15 (with 5x coax cables)